

Cable Tray Support Bracket

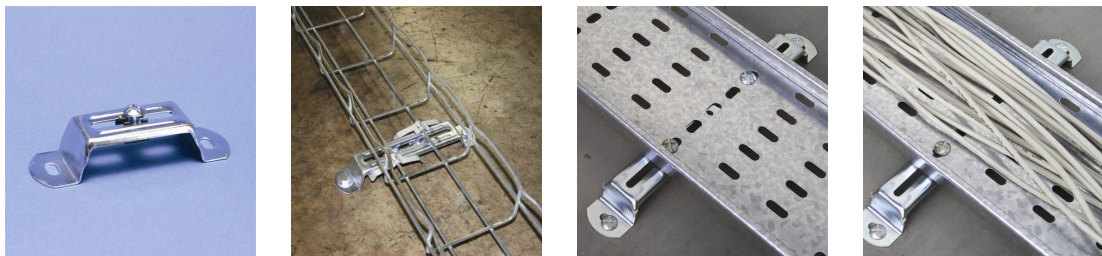

- Secures wire basket mesh or perforated cable trays to either vertical or horizontal masonry surfaces
- Accommodates cable tray from 50 mm to 450 mm wide
- Includes two M6 adjustable captive nuts and two M6 round bolts for securing perforated tray
- Works with the KBT Wire Basket Tray Clip for securing wire basket cable tray

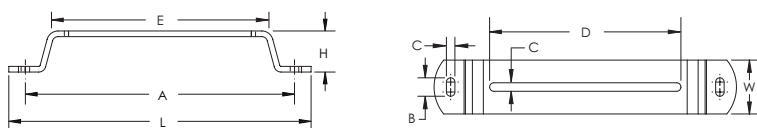

Material: Steel

Finish: Electrogalvanized

Part Number	Article Number	Height H	Length L	Width W	A	B	C	D	E
ECTB1	175640	25 mm	122 mm	38 mm	96.5 mm	6.5 mm	13 mm	43.0 mm	63.5 mm
ECTB2	175650	25 mm	186 mm	38 mm	160.5 mm	6.5 mm	13 mm	107.0 mm	127.0 mm
ECTB3	175660	25 mm	283 mm	38 mm	257.5 mm	6.5 mm	13 mm	205.0 mm	225.0 mm
ECTB4	175670	25 mm	360 mm	38 mm	333.5 mm	6.5 mm	13 mm	278.5 mm	298.5 mm
ECTB5	175950	25 mm	520 mm	38 mm	494.5 mm	6.5 mm	13 mm	440.0 mm	460.0 mm

WARNING

ERICO products shall be installed and used only as indicated in ERICO's product instruction sheets and training materials. Instruction sheets are available at www.erico.com and from your ERICO customer service representative. Improper installation, misuse, misapplication or other failure to completely follow ERICO's instructions and warnings may cause product malfunction, property damage, serious bodily injury and death.

Copyright © 2015 ERICO International Corporation. All rights reserved.

CADDY, CADWELD, CRITEC, ERICO, ERIFLEX, ERITECH, and LENTON are registered trademarks of ERICO International Corporation.

