

Air Terminal Base, Horizontal Bond, Imperial Thread

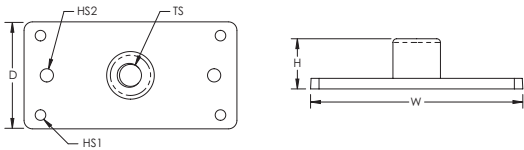

- Bonds directly to horizontal structural steel surface



Part Number	Thread Size TS	Hole Size 1 HS1	Hole Size 2 HS2	Depth D	Height H	Width W	Unit Weight
Material: Aluminum							
LPA34012	1/2 UNC	5.1 mm	6.4 mm	50.8 mm	24.13 mm	101.6 mm	0.073 kg
LPA34058	5/8 UNC	5.1 mm	6.4 mm	50.8 mm	24.13 mm	101.6 mm	0.073 kg
Material: Copper							
LPC34038	3/8 UNC	5.1 mm	6.4 mm	50.8 mm	24.13 mm	101.6 mm	0.240 kg
LPC34012	1/2 UNC	5.1 mm	6.4 mm	50.8 mm	24.13 mm	101.6 mm	0.240 kg
LPC34058	5/8 UNC	5.1 mm	6.4 mm	50.8 mm	24.13 mm	101.6 mm	0.240 kg

UL, UR, cUL, cUR, cULus and cURus are registered certification marks of UL LLC.

WARNING

ERICO products shall be installed and used only as indicated in ERICO's product instruction sheets and training materials. Instruction sheets are available at www.erico.com and from your ERICO customer service representative. Improper installation, misuse, misapplication or other failure to completely follow ERICO's instructions and warnings may cause product malfunction, property damage, serious bodily injury and death.

Copyright © 2015 ERICO International Corporation. All rights reserved.

CADDY, CADWELD, CRITEC, ERICO, ERIFLEX, ERITECH, and LENTON are registered trademarks of ERICO International Corporation.

