

Air Terminal Base, Horizontal Mount, Imperial Thread

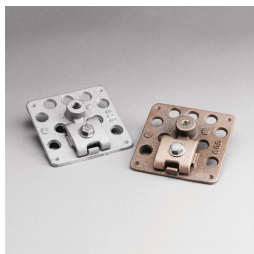

- Can be fastened mechanically or bonded using hot pitch, roofing compound or commercial adhesive on built-up roof surfaces or other location where holes cannot be made
- Positive single bolt tension for multi-directional cable clamping

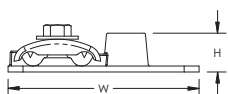
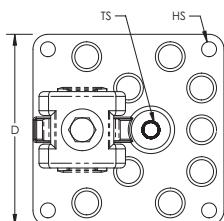

Conductor Size, UL: Class 1 - Class 2 (4/0 Max)

Part Number	Thread Size TS	Hole Size HS	Depth D	Height H	Width W	Unit Weight
Material: Aluminum						
LPA30912	1/2 UNC	7.94 mm	101.6 mm	20.64 mm	101.6 mm	0.141 kg
LPA30958	5/8 UNC	7.94 mm	101.6 mm	20.64 mm	101.6 mm	0.141 kg
Material: Copper						
LPC30912	1/2 UNC	7.94 mm	101.6 mm	20.64 mm	101.6 mm	0.440 kg
LPC30938	3/8 UNC	7.94 mm	101.6 mm	20.64 mm	101.6 mm	0.440 kg
LPC30958	5/8 UNC	7.94 mm	101.6 mm	20.64 mm	101.6 mm	0.440 kg
Material: Copper – Finish: Tinned						
LPC309L12	1/2 UNC	7.94 mm	101.6 mm	20.64 mm	101.6 mm	0.440 kg
LPC309L38	3/8 UNC	7.94 mm	101.6 mm	20.64 mm	101.6 mm	0.440 kg
LPC309L58	5/8 UNC	7.94 mm	101.6 mm	20.64 mm	101.6 mm	0.440 kg

UL, UR, cUL, cUR, cULus and cURus are registered certification marks of UL LLC.

WARNING

ERICO products shall be installed and used only as indicated in ERICO's product instruction sheets and training materials. Instruction sheets are available at www.erico.com and from your ERICO customer service representative. Improper installation, misuse, misapplication or other failure to completely follow ERICO's instructions and warnings may cause product malfunction, property damage, serious bodily injury and death.

Copyright © 2015 ERICO International Corporation. All rights reserved.

CADDY, CADWELD, CRITEC, ERICO, ERIFLEX, ERITECH, and LENTON are registered trademarks of ERICO International Corporation.

