

SIM Stainless Steel Mast Base

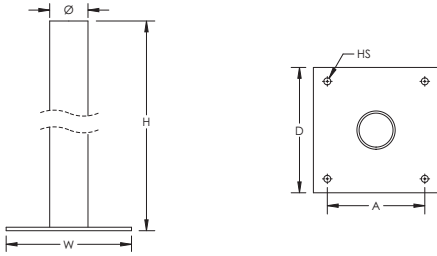

- Provides mounting point for SIM Stainless Steel Mast



Material: Stainless Steel 304L

Part Number	Height H	Width W	Depth D	Diameter Ø	Hole Size HS	A	Unit Weight
SIMBASE2840	153 mm	200 mm	200 mm	33 mm	11 mm	170 mm	1.232 kg

WARNING

ERICO products shall be installed and used only as indicated in ERICO's product instruction sheets and training materials. Instruction sheets are available at www.erico.com and from your ERICO customer service representative. Improper installation, misuse, misapplication or other failure to completely follow ERICO's instructions and warnings may cause product malfunction, property damage, serious bodily injury and death.

Copyright © 2015 ERICO International Corporation. All rights reserved.

CADDY, CADWELD, CRITEC, ERICO, ERIFLEX, ERITECH, and LENTON are registered trademarks of ERICO International Corporation.

