

# Right Angle Extension Adaptor

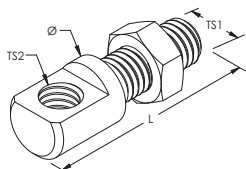

- Provides an additional 2" (50.8 mm) offset when used with air terminal bases
- Can be coupled with Imperial Adaptors to provide a total of 3" (76.2 mm) offset



Part Number	Thread Size 1 TS1	Thread Size 2 TS2	Length L	Diameter Ø	Unit Weight
<b>Material: Aluminum</b>					
LPA29612	1/2 UNC	1/2 UNC	68.3 mm	23.8 mm	0.036 kg
LPA29658	5/8 UNC	5/8 UNC	68.3 mm	23.8 mm	0.036 kg
<b>Material: Copper</b>					
LPC29612	1/2 UNC	1/2 UNC	68.3 mm	23.8 mm	0.082 kg
LPC29638	3/8 UNC	3/8 UNC	68.3 mm	23.8 mm	0.082 kg
LPC29658	5/8 UNC	5/8 UNC	68.3 mm	23.8 mm	0.082 kg

UL, UR, cUL, cUR, cULus and cURus are registered certification marks of UL LLC.

#### WARNING

ERICO products shall be installed and used only as indicated in ERICO's product instruction sheets and training materials. Instruction sheets are available at [www.erico.com](http://www.erico.com) and from your ERICO customer service representative. Improper installation, misuse, misapplication or other failure to completely follow ERICO's instructions and warnings may cause product malfunction, property damage, serious bodily injury and death.

Copyright © 2015 ERICO International Corporation. All rights reserved.

CADDY, CADWELD, CRITEC, ERICO, ERIFLEX, ERITECH, and LENTON are registered trademarks of ERICO International Corporation.

